

# Workbench 2.0 Interaction Documentation

Development Sponsored by Palantir.net | August 29, 2011

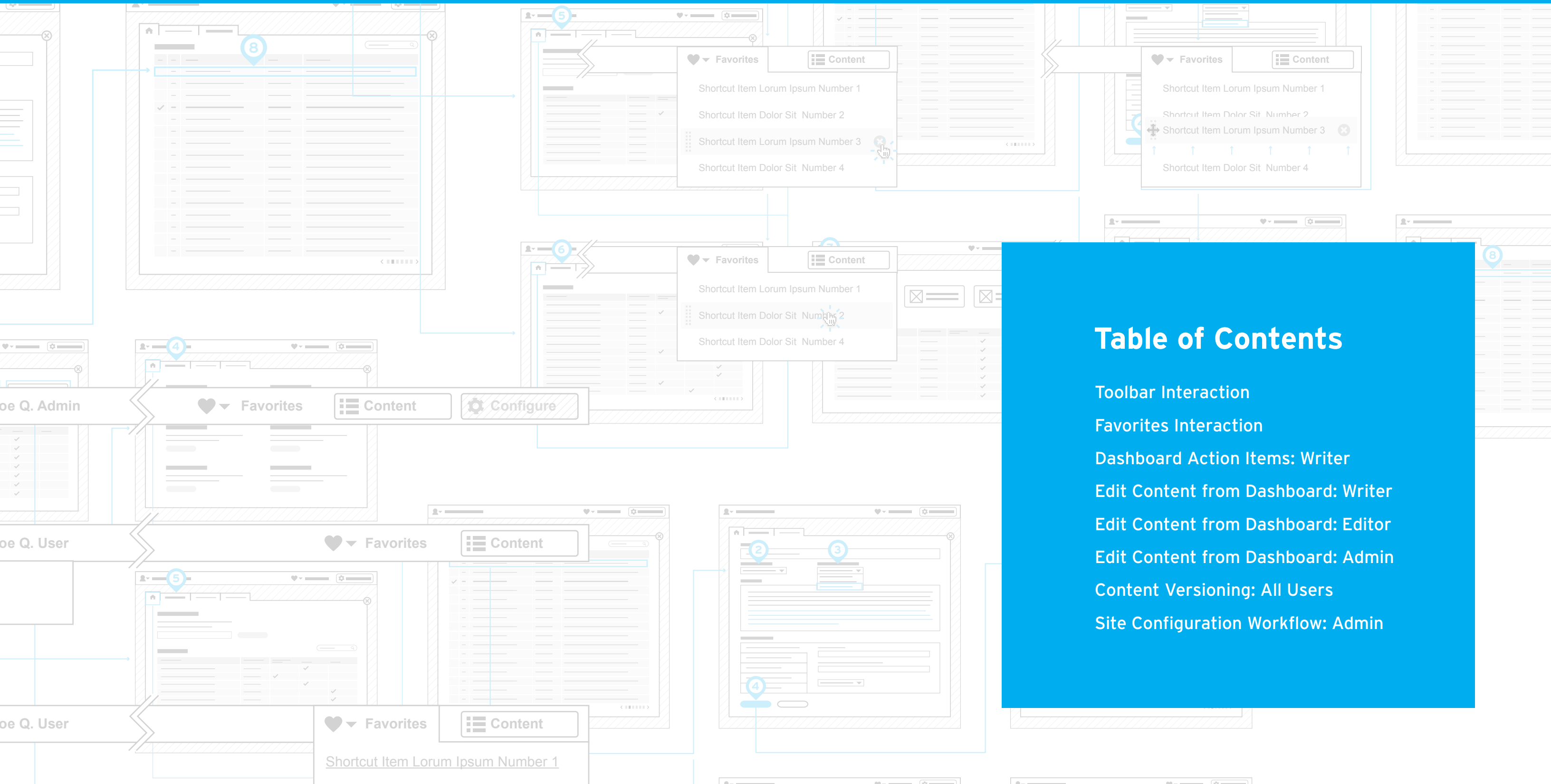

## Table of Contents

Toolbar Interaction

Favorites Interaction

Dashboard Action Items: Writer

Edit Content from Dashboard: Writer

Edit Content from Dashboard: Editor

Edit Content from Dashboard: Admin

Content Versioning: All Users

Site Configuration Workflow: Admin

# Toolbar Interaction

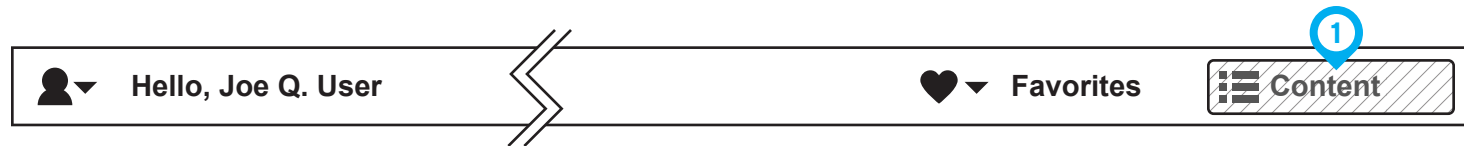
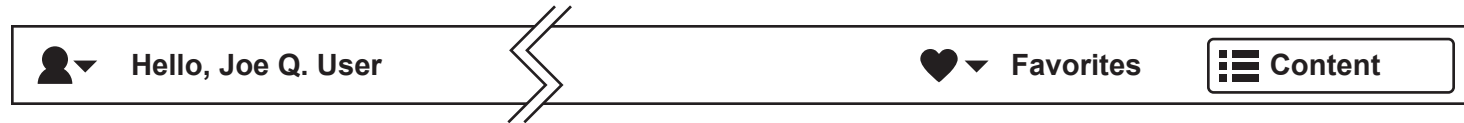

The content modal overlay can be toggled on and off with this button.



The site configuration modal overlay can be toggled on and off with this button. There may be only one active at any time. (admin only)

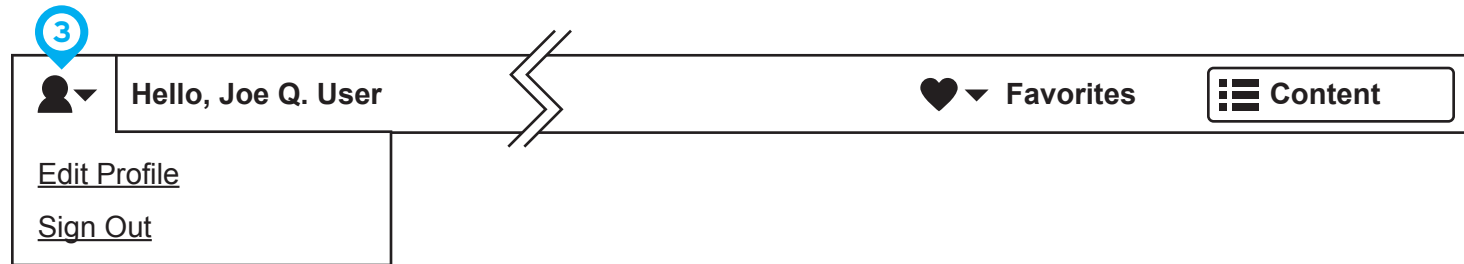

This dropdown contains links to profile management and sign out.

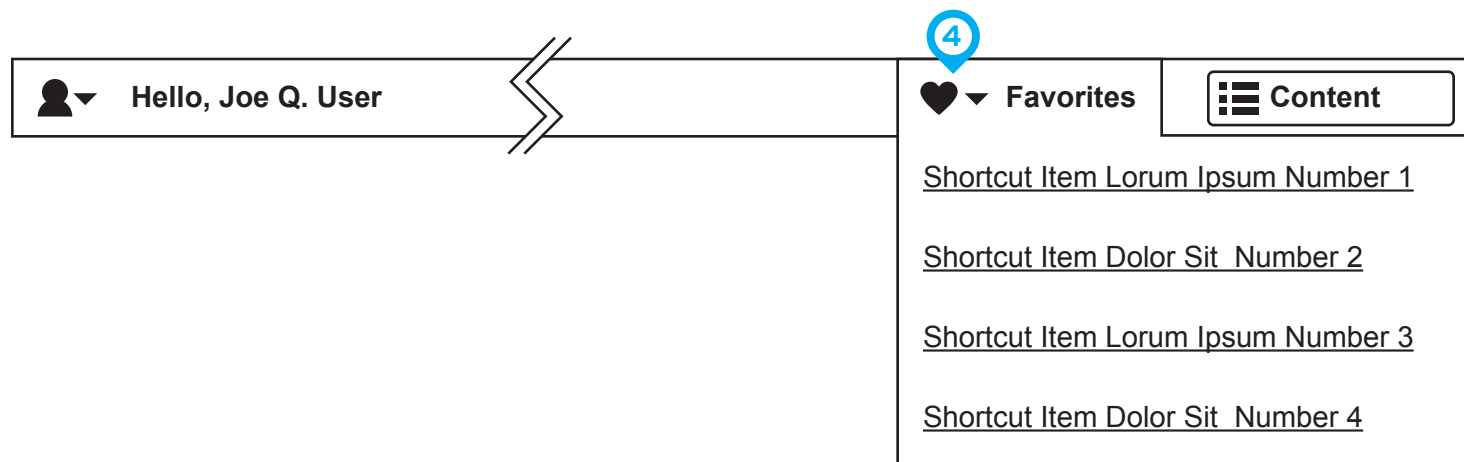

This dropdown contains links to favorite pages. This list is currently tied to user type but would be a more useful feature if each user could manage his or her own shortcuts.

# Favorites Interaction

The favorites dropdown contains items selected by the user. They can be content or configure pages that are repetitive tasks. The behavior of the dropdown is click/toggle as opposed to hover.

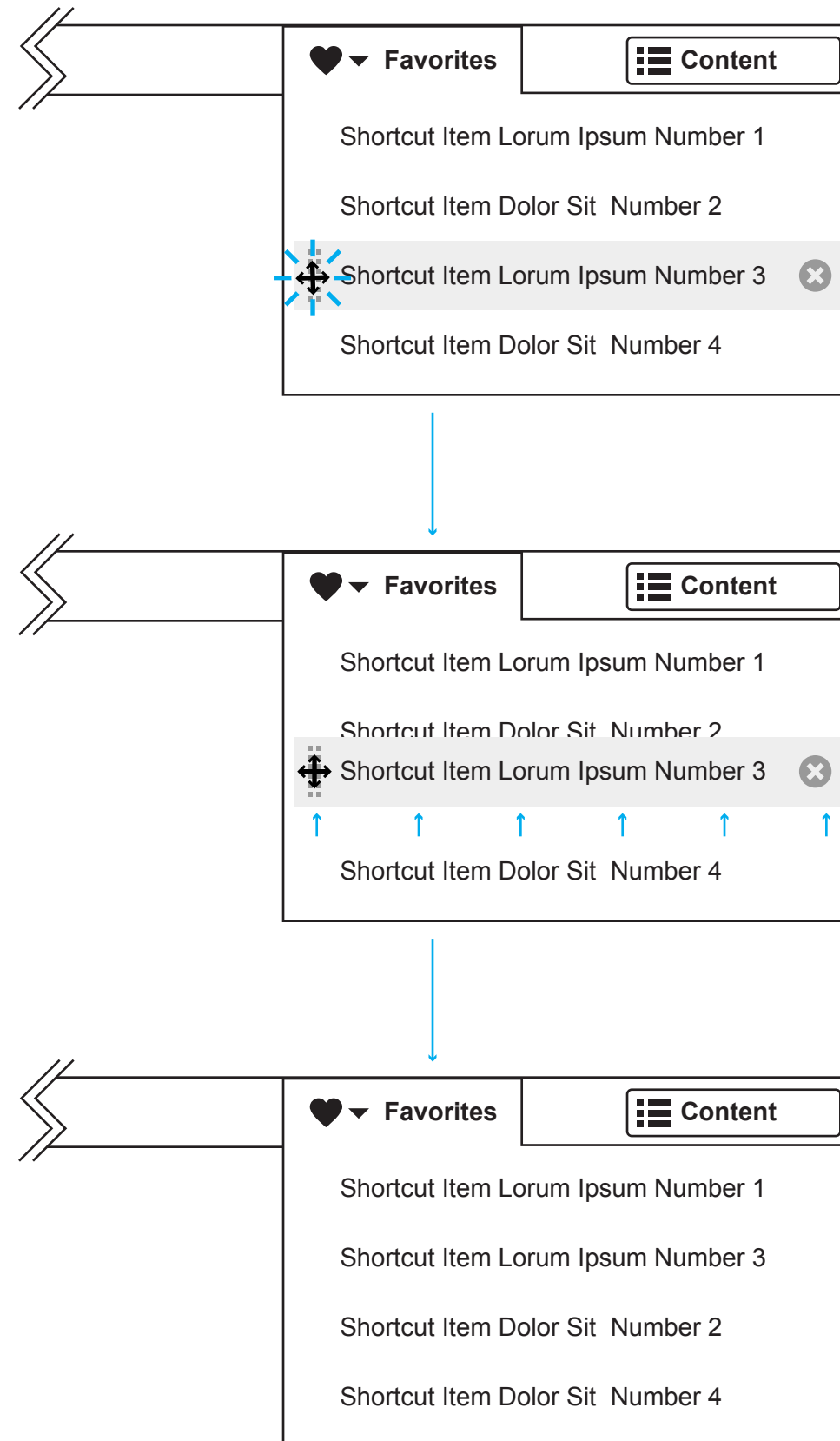
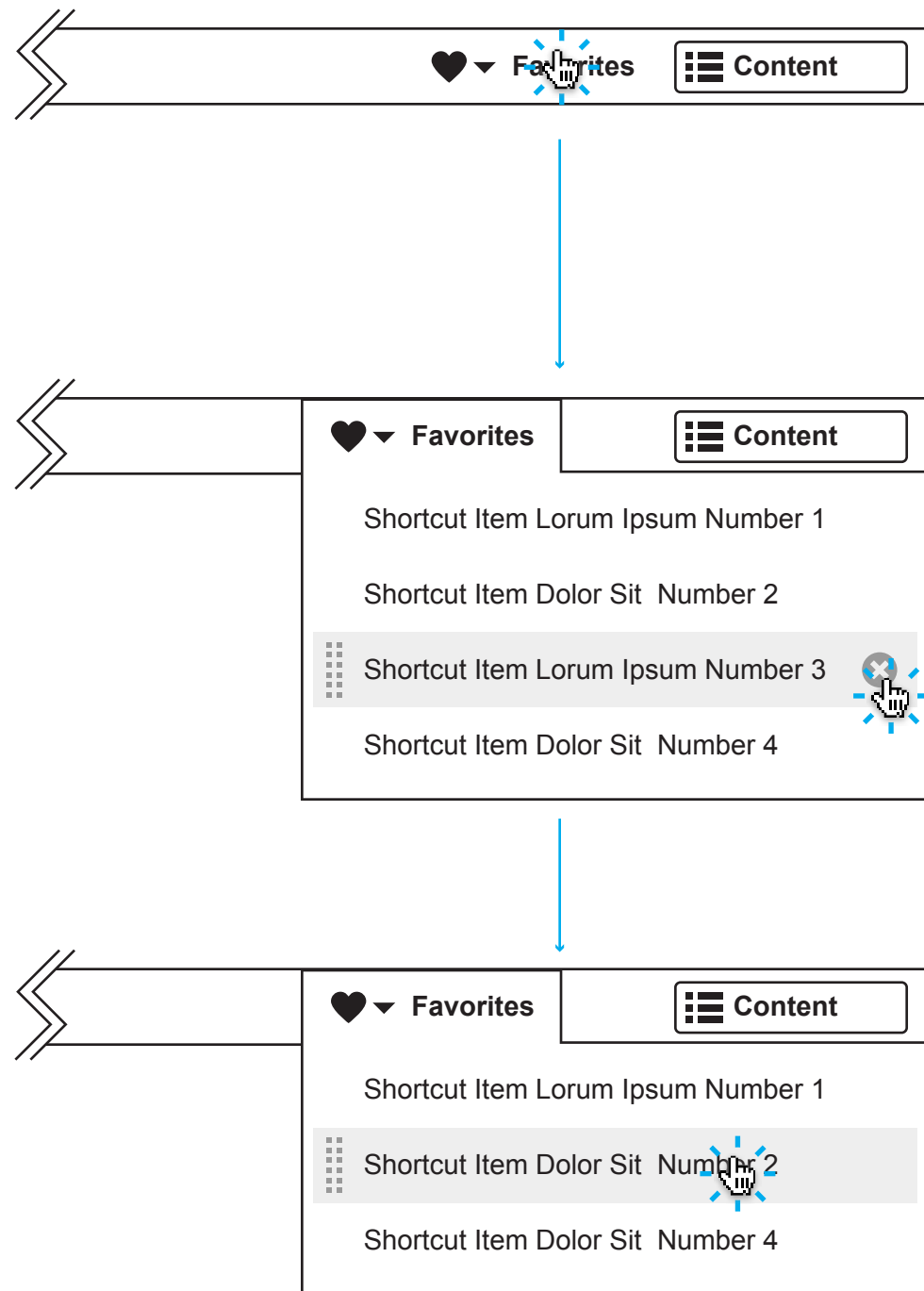

The cursor changes to the move icon when hovered on an item in the favorites list. The background of the div changes and the "x" for delete appears as well.

The user may click-hold-drag each div in the list.

The favorites items are now in a new preferred order.

## Action Items: Writer Dashboard

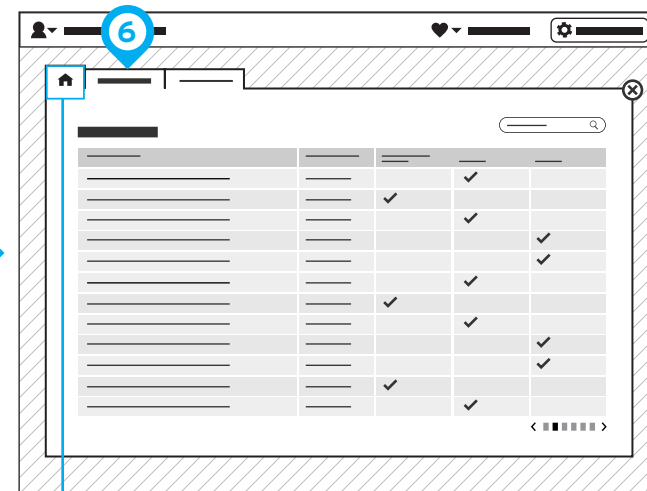
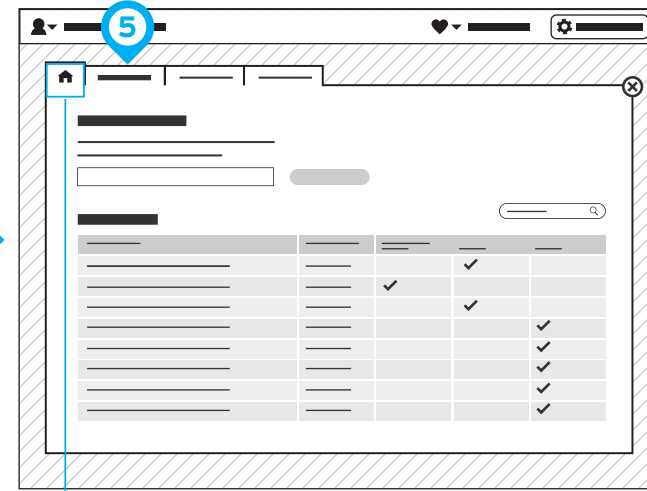
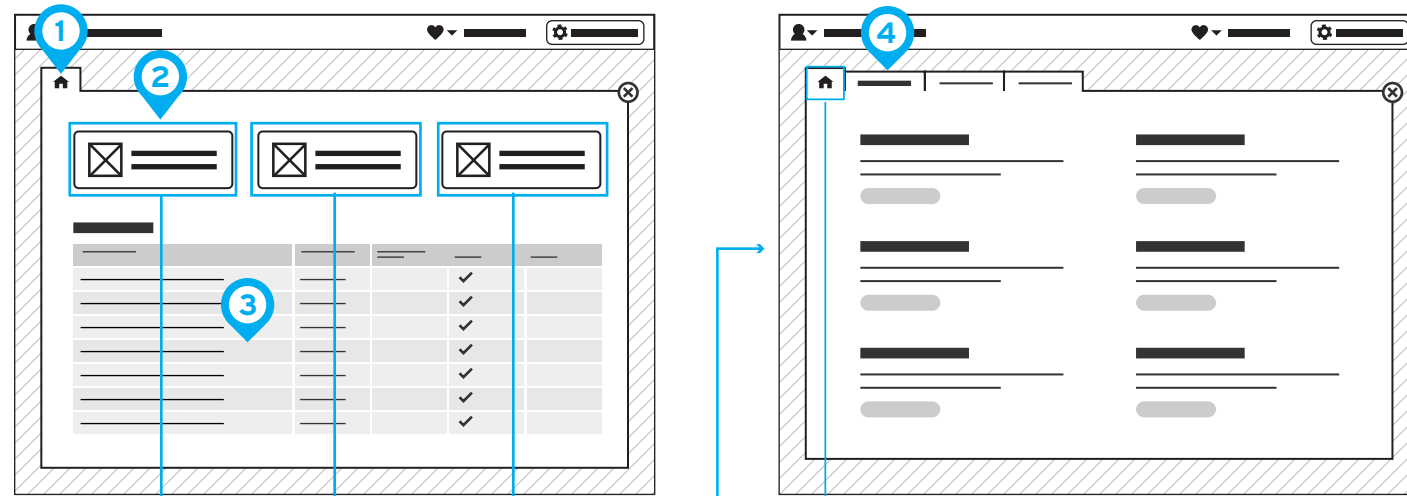

- 1 There will be navigational tabs at the top of the modal window. The left-most tab with a home icon is for dashboard home. This is the default view when workbench is toggled on.
- 2 Action Items. In the design i'd like this to be image and text or perhaps large buttons. The actions may vary per user type. For the writer persona, from left to right: "Create New Content," "File Uploads," and "Archives."
- 3 Underneath the action areas is a list of recent activity for that user's content. This is limited to screen space but should be about 10 items or so.
- 4 When the "Create New Content" action area is clicked, the page redirects and a new set of tabs appears next to the "Dashboard Home" tab for creating new content. There could be thumbnails for types, or text descriptions and buttons or whatever makes the most sense.
- 5 When the "File Uploads" action area is clicked, the page redirects and a new set of tabs appears next to the "Dashboard Home" tab for file uploads. There should be a text prompt and a button to upload a file. Underneath could be a list similar to that of the article list.
- 6 When the "Archive" action area is clicked, the page redirects and a new set of tabs appears next to the "Dashboard Home" tab for archives. This is to show the user every piece of content they've worked on since day one. This file list will either have to grow vertically or have page controls to accomodate growth.
- 7 The user may click the "Dashboard Home" tab at any time to return to the dashboard's default view.

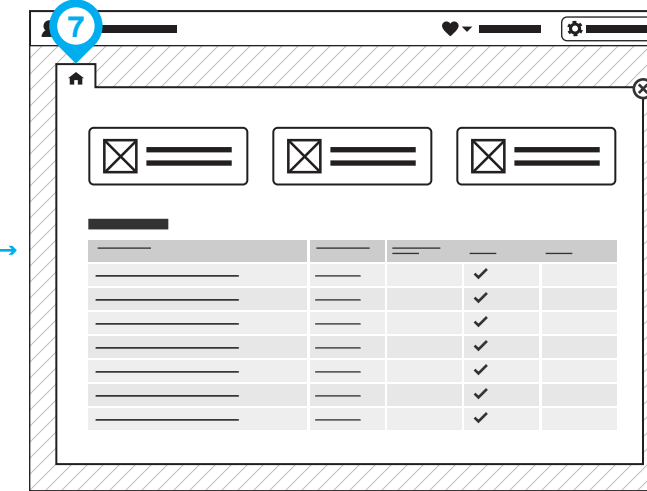

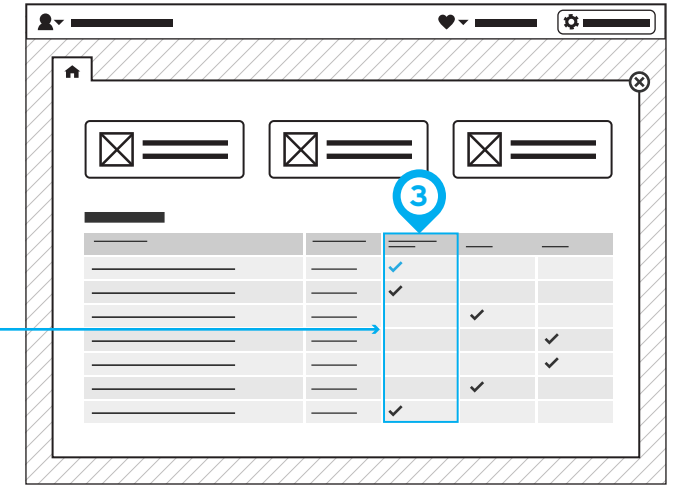
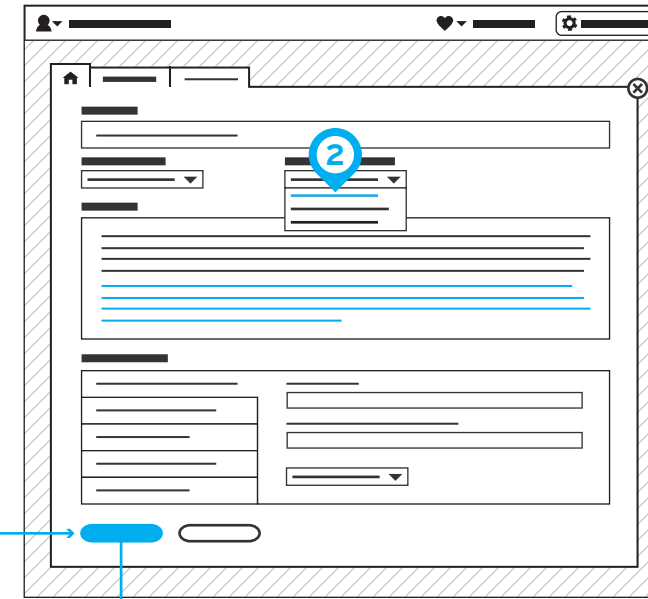
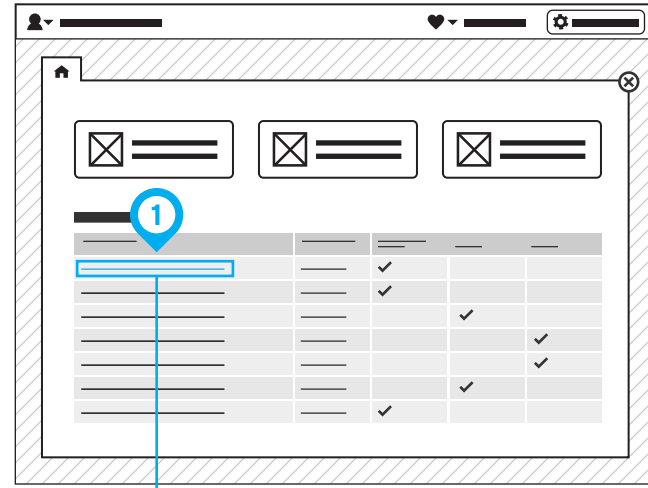

## Content Edit From Dashboard: Writer

- 1 The title to a piece of content is clicked and opens the edit screen, which appears in the same modal window.
- 2 Updates are made to the content with the WYSIWYG editor, user selects "Save as draft" in the dropdown menu and clicks the save button.
- 3 The dashboard screen loads again. The table has been updated: the checkmark stays in the "Draft" status column.
- 4 Updates are made to the content with the WYSIWYG editor, user selects "Post for Review" in the dropdown menu and clicks the save button.
- 5 The dashboard screen loads again. The table has been updated: the checkmark has moved to the "In-Review" status column.
- 6 Updates are made to the content with the WYSIWYG editor, user selects "Publish" in the dropdown menu and clicks the save button.
- 7 The dashboard screen loads again. The table has been updated: the checkmark has moved to the "Published" status column.

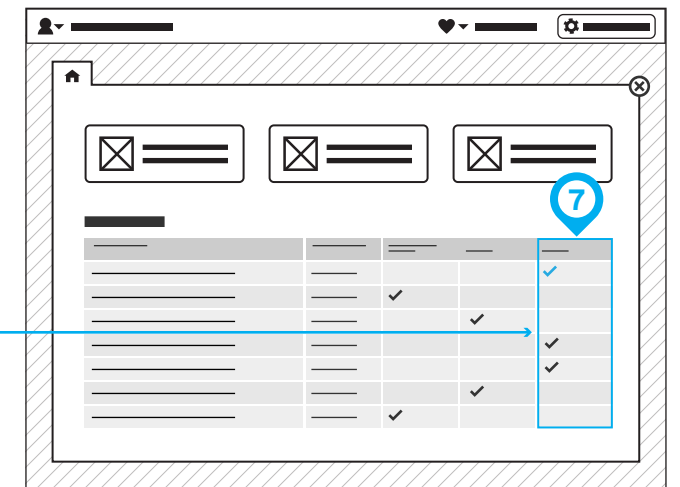
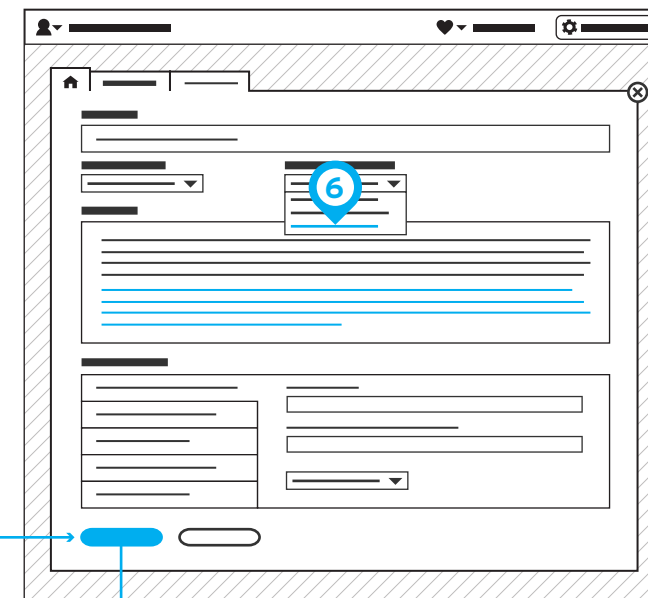
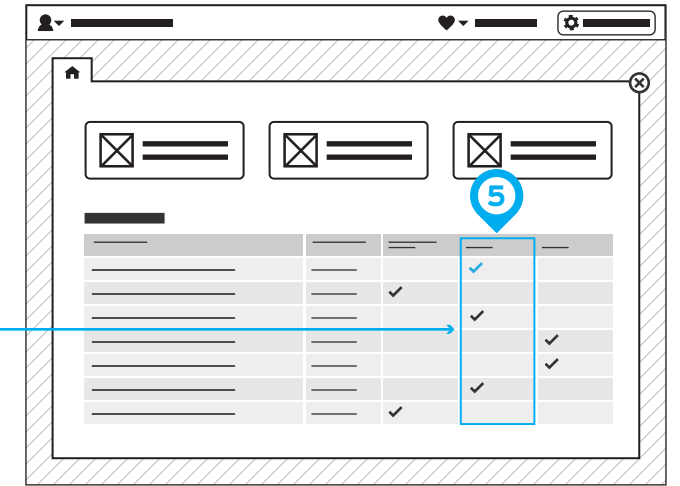

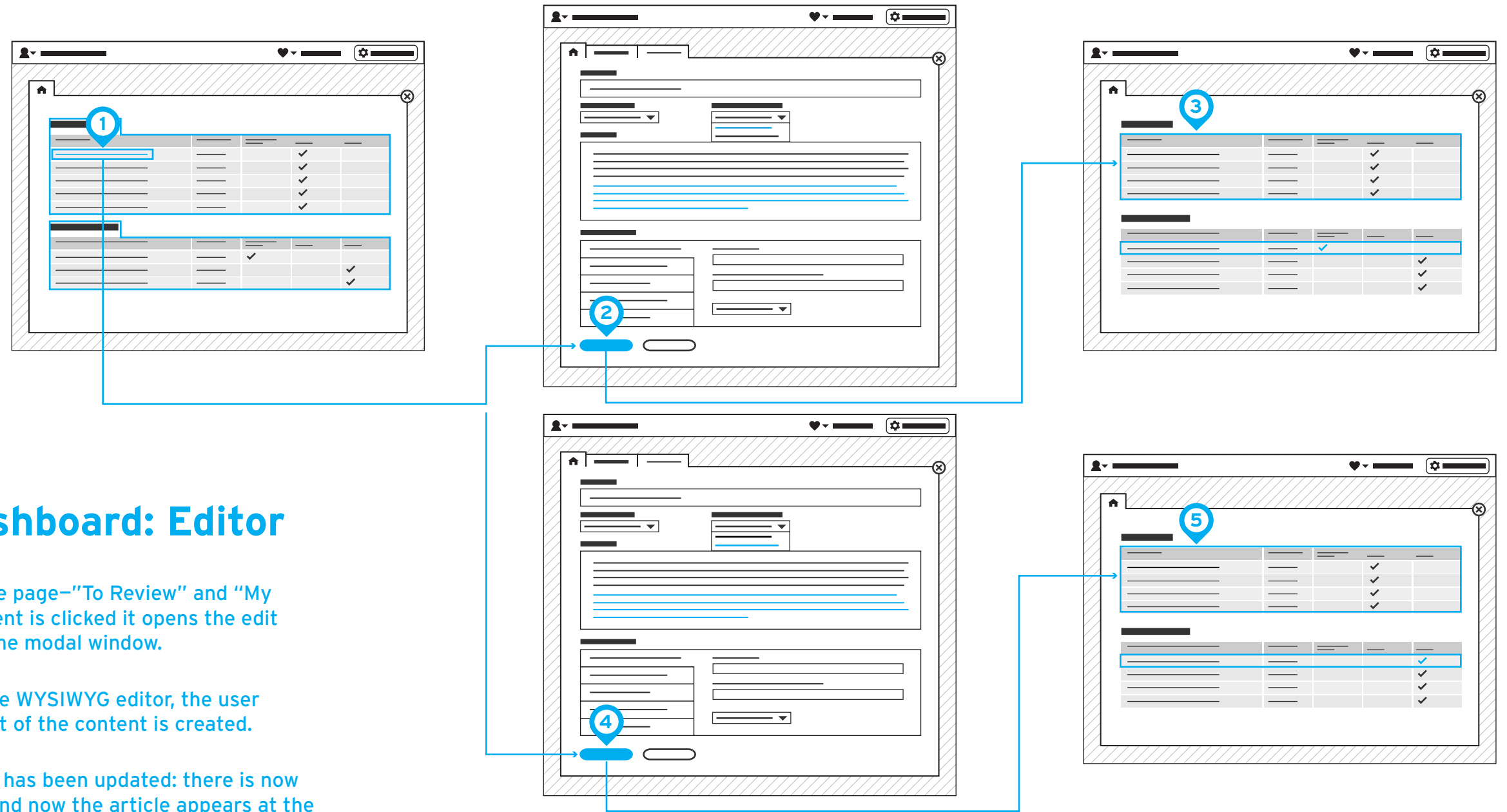

## Content Edit From Dashboard: Editor

- 1 The dashboard loads with two lists on the page—"To Review" and "My Content." When a title to a piece of content is clicked it opens the edit content screen, which appears in the same modal window.
- 2 Updates are made to the content with the WYSIWYG editor, the user clicks "Save as draft" button. A new draft of the content is created.
- 3 The dashboard screen reloads. The table has been updated: there is now one less article in the "To Review" list. And now the article appears at the top of the "My Content" list with a checkmark in the "Draft" column.
- 4 Updates are made to the content with the WYSIWYG editor, the user clicks the "Publish" button. The content in the WYSIWYG window is published to the live site.
- 5 The dashboard screen reloads. The table has been updated: there is now one less article in the "To Review" list. And now the article appears at the top of the "My Content" list with a checkmark in the "Published" column.

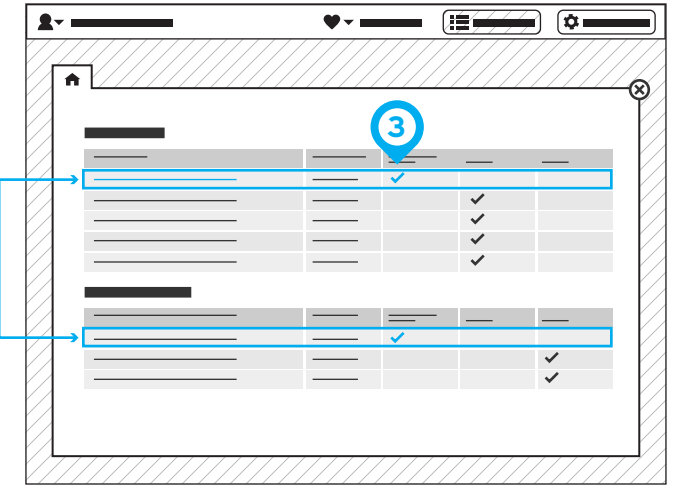
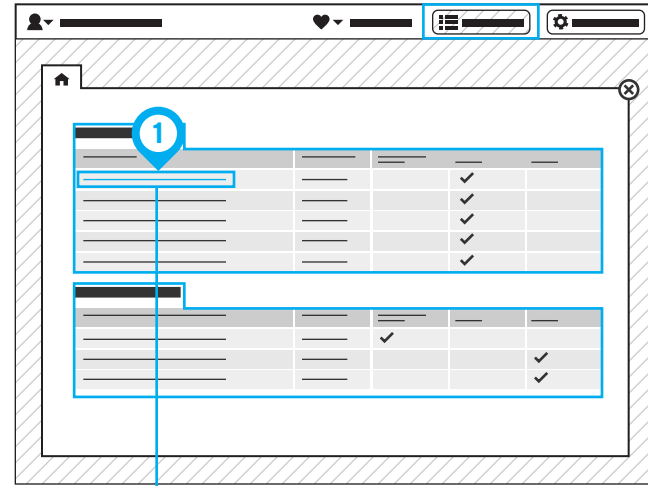

## Content Edit From Dashboard: Admin

- 1 The dashboard loads with two lists on the page—"Recent Activity" and "My Content." When a title to a piece of content is clicked it opens the edit content screen, which appears in the same modal window.
- 2 Updates are made to the content with the WYSIWYG editor, the user selects "Save as draft" from the "File Status" dropdown and clicks the save button. A new draft of the content is created.
- 3 The dashboard screen reloads. The tables have been updated: The new draft is positioned at the top of both lists and the checkmarks are now in the "Draft" status columns.
- 4 Updates are made to the content with the WYSIWYG editor, the user selects "Publish" from the "File Status" dropdown menu and clicks the save button. The current draft of the content is pushed to the live site.
- 5 The dashboard screen reloads. The tables have been updated: The article is positioned at the top of both lists and the checkmarks are now in the "Published" status columns.
- 6 To remove a piece of content that's been published to the live site, the admin may select "Unpublish" from the "File Status" dropdown menu and click save.
- 7 The piece of content is reverted back to draft status and is positioned at the top of both lists and the checkmarks are now in the "In-Review" status column again.

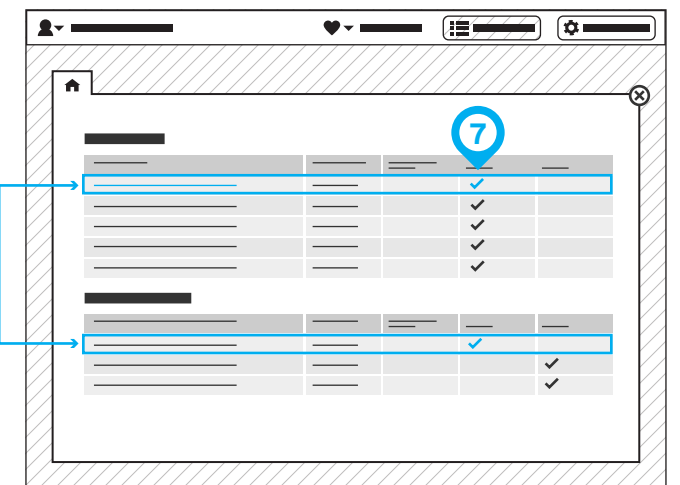
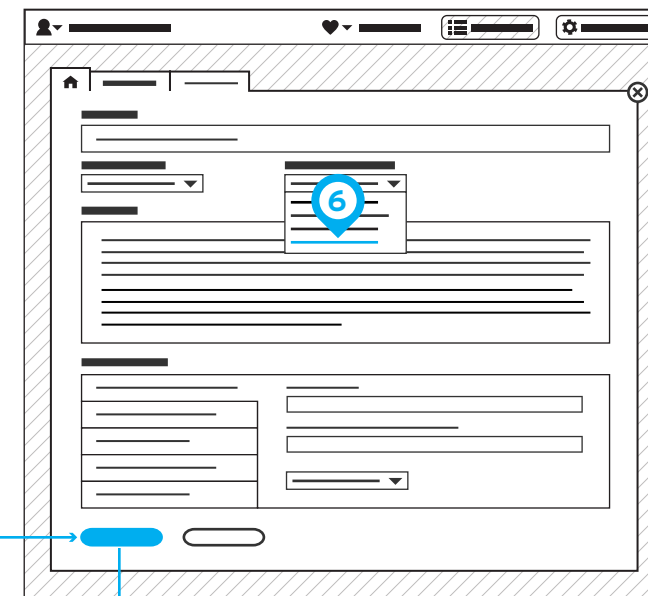
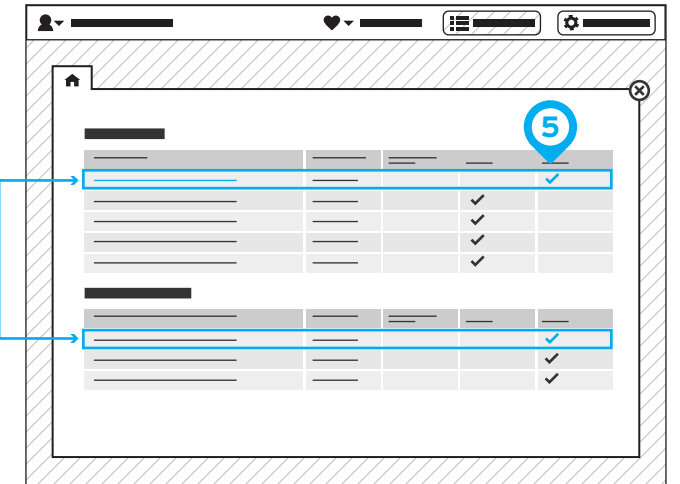
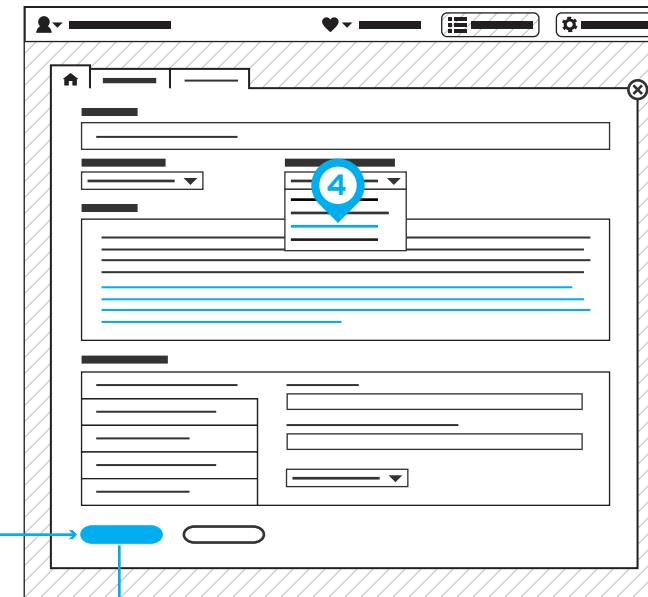



## Content Versioning: All Users

- 1 The "history" tab shows all versions of a piece of content ever created. The newest draft version is selected at the top of the list. Note that the published version is two rows down and called out with a checkmark.
- 2 The content page opens to the "Edit" tab. The section and status of this piece of content are displayed in pre-populated dropdown menus.
- 3 Edits are made to the body copy and "publish" is selected from the status dropdown menu.
- 4 The user chooses to save. This creates a new version of the content and posts it to the live site.
- 5 The list reloads. A new version of the content has been created and appears at the top of the list with the checkmark to denote that it's currently published to the live site.
- 6 If instead, the user chooses to select draft under the status dropdown and then saves the content...
- 7 ...The list reloads and a new version has been created and placed on the top of the list but the published version remains unchanged and moves down one more row in the list.



# Site Configuration Workflow: Admin

- 1 Users with admin rights will have an additional toggle button in the toolbar. If the "content" button is pressed, the editor dashboard appears in the modal overlay.
- 2 If the "configure" button is pressed, a new modal overlay loads containing all the site configuration options in a multi-column list. This is very much in the spirit of the current config page with the addition of all the extra links that were floating around in the toolbar.
- 3 The format is headers with list item links. If a list item in configuration options is clicked, then that page of options loads in the modal overlay.
- 4 Any related pages are shown as tabbed navigation, as before.
- 5 Changes are made on the options page and save is clicked.
- 6 The admin dashboard reloads. The user may also click the home tab to return to this screen at any time. Repeat.

